

# Office to let



## One Cotroceni Park III

Bucharest, Sector 6, 44 Sergent Nutu Ion st.

### Building information

Building status	Planned
Year of construction	2025
Parking ratio	To be agreed
Total building area	46 000 sq m

### Commercial terms

Office space*	after login *
Parking	after login *
Service charge*	after login *
Minimum lease term	after login *
Availability	after login *

\* Asking terms for m<sup>2</sup>/month

### Location



### Available space

Building completely leased

## Typical floor plan

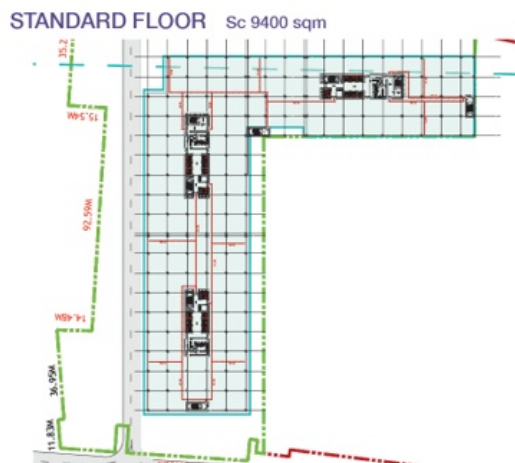

## Public transport

Bus: 122, 123, 136, 196, 226

Tram: 8, 25

Contact



+40 21 302 3400

More information